

PZ26- 12000001
04/01/2026



PZ26- 12000001
05/20/2026

Pompano Beach, FL 33060
PH: (954) 788-3400

Florida Engineering Business License: CA7928
Florida Surveyor and Mapper Business License: LB6860
Florida Landscape Architecture Business License: LC2600045

[illegible]

PRELIMINARY PLAN
NOT FOR CONSTRUCTION

**THESE PLANS ARE NOT FULLY PERMITTED
AND ARE SUBJECT TO REVISIONS MADE
DURING THE PERMITTING PROCESS.**

RESPONSIBILITY FOR THE USE OF THESE
PLANS PRIOR TO OBTAINING PERMITS FROM
ALL AGENCIES HAVING JURISDICTION OVER
THE PROJECT WILL FALL SOLELY UPON THE
USER.

ISSUE DATE: 02/25/2026

DESIGNED BY: SL, KU

DRAWN BY: KU, EZ

BID-CONTRACT:

PAUL H. WEINBERG, PLA
ORIDA REG. NO. LA6666804
(FOR THE FIRM)

CLIENT

**RP
POMPA
LLC**

PROJECT

DOWNTOWN POMPANO

SHEET TITLE

PHOTOMETRIC PLAN

SHEET 11-102

PROJECT NUMBER	15083.00
----------------	----------

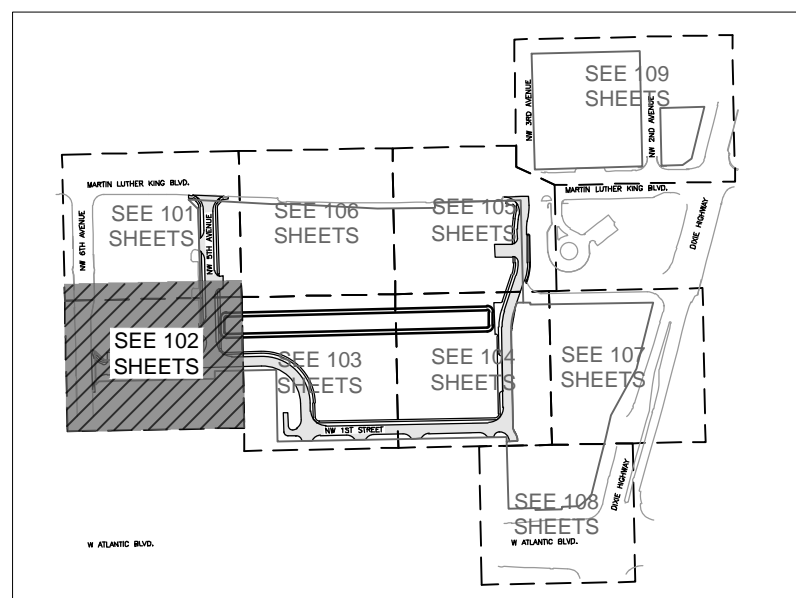

KEY PLAN

MATCH LINE: REF. SHEET LL-101

MATCH LINE: REF. SHEET LL-103

Luminaire Schedule								
Symbol	Qty	Label	Arrangement	Lum. Lumens	LLD	Luminaire Watts	Total Watts	Description
	24	L1	Single	6172	1,000	54.4	1305.6	LUMEC. 0N20-55W2XLED-4K-G3-ACRD-1E2R-URW-DIM (P/OLE MT0 30° A.F. G)

Calculation Summary								
Label	CalcType	Units	Avg	Max	Min	AvgMin	MaxMin	Grid Z
ROADWAY	Illuminance	Fc	1.09	2.1	0.5	2.18	4.20	0

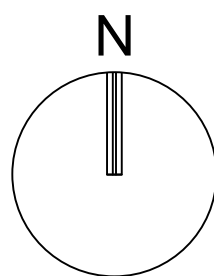

GRAPHIC SCALE

SCALE: 1" = 20'

NOTE: PRINTED DRAWING SIZE
MAY HAVE CHANGED FROM
ORIGINAL. VERIFY SCALE USING
BAR SCALE ABOVE.

Drawing name: H:\15083.00 - Downtown Pompano - RP Development LLC\Landscap Architecture\CAD\15083.00-LL-1XX.dwg

STATUIS. PRELIMINARY